

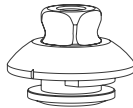

endolite

get busy living

4 Bolt ESK+ 239150



endolite

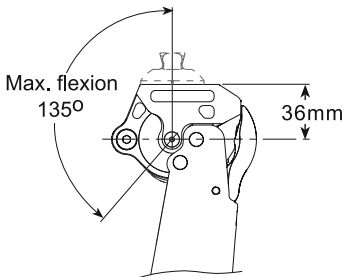
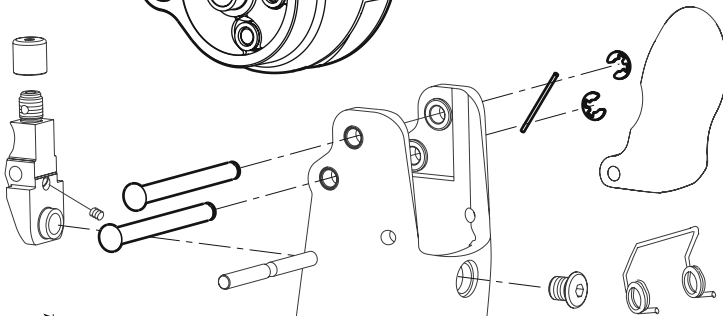
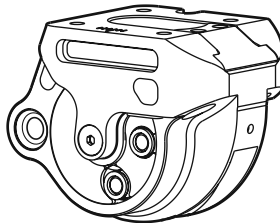

endolite

1 Static Alignment Guide

Walking trials

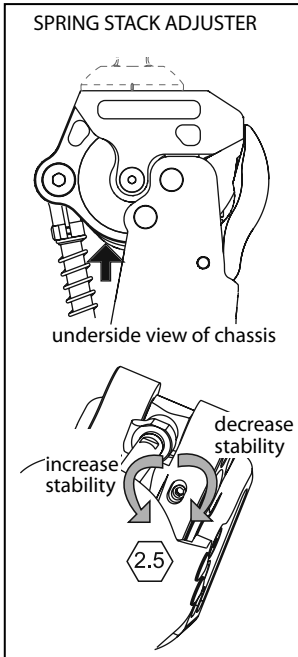

Fully extend limb to access the adjuster. Rotate the SPRING STACK ADJUSTER to achieve the required stability for the individual user. *Note: Audible clicks should be heard upon adjustment, and the adjuster is self locking.* Tighten the SPRING STACK to reduce stability. Release the SPRING STACK to increase stability - See above diagram.

If required, the adjuster may be reset to the factory setting. This can be achieved by reducing stability by six audible clicks from the maximum setting.

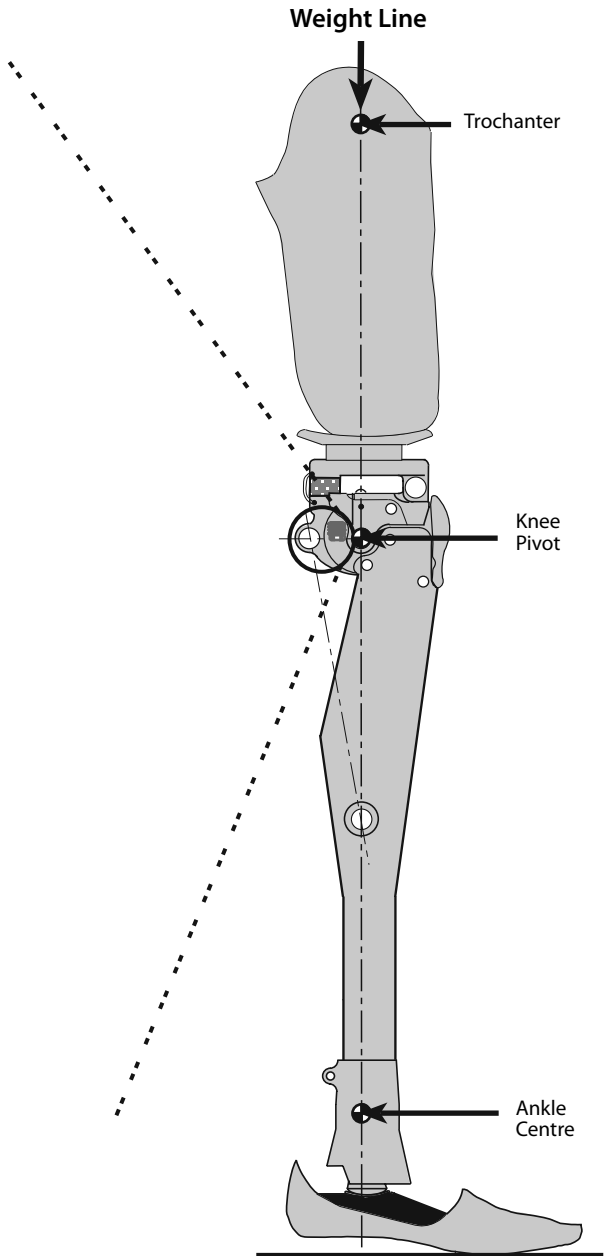

2 Front Stop adjustment - Adjustable Trunnion

As fitted to the PSPC and Servo PSPC

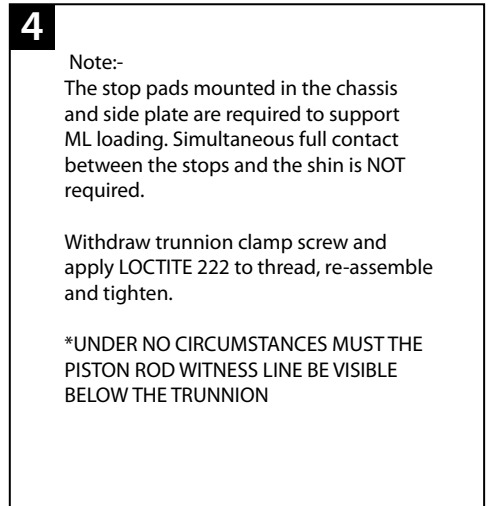
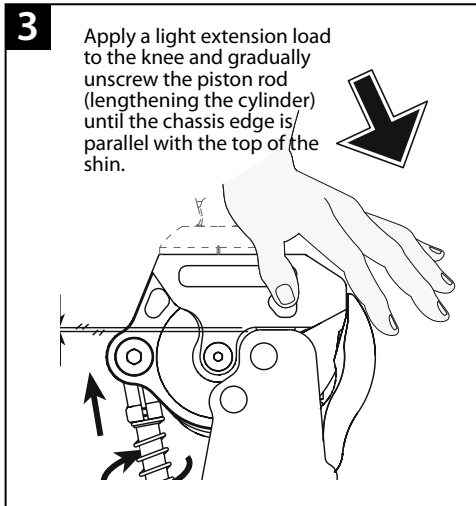
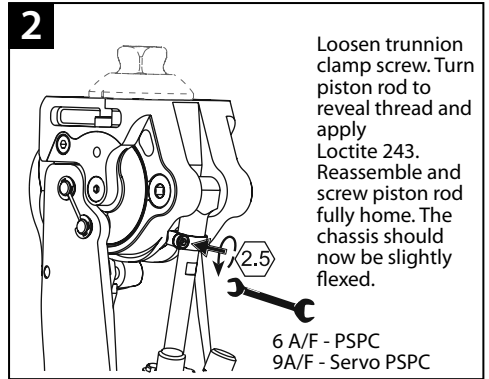
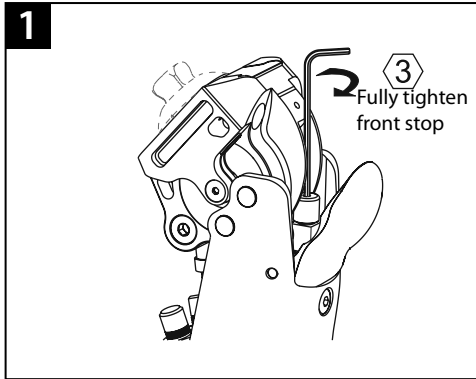

Servo PSPC

The Servo PSPC should be adjusted as above except the trunnion should be rotated further, if required, until the cut-out in the piston rod is posterior.

Front Stop adjustment - Non-Adjustable Trunnion

[As fitted to the IP+ and Hydraulic Cylinders]

No adjustment is necessary when using these cylinders. They require the front stop to be fully tightened as shown in Stage 1.

3 Maintenance

To maintain optimum performance, a periodic inspection for unacceptable noise, play and stability is recommended. The period between inspections is determined by factors such as the activity of the user, frequency of usage and the stability setting of the knee.

At these inspections:

Check and replace front stop if necessary (see page 5).

Dis-assemble, clean and re-assemble as shown on pages 6 & 7.

As a guide, if the setting is 6 clicks or above and the user averages 600,000 steps per annum, an annual inspection is recommended.

If the stability setting is less than 6 clicks and/or the user averages fewer than the average number of steps, the period inbetween inspections may be longer.

The use of a Limb Activity Monitor is recommended to determine step count.

Adjustment and maintenance must be carried out by competent, trained personnel.

If in doubt contact Blatchford Products Limited.

4 Changing front stop buffer

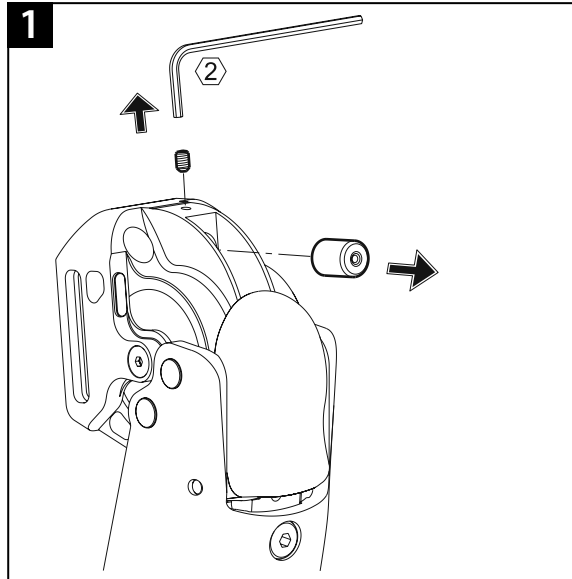

When fitting a new front stop, always re-adjust, and if applicable check length of cylinder if fitted with an adjustable trunnion. See page 3

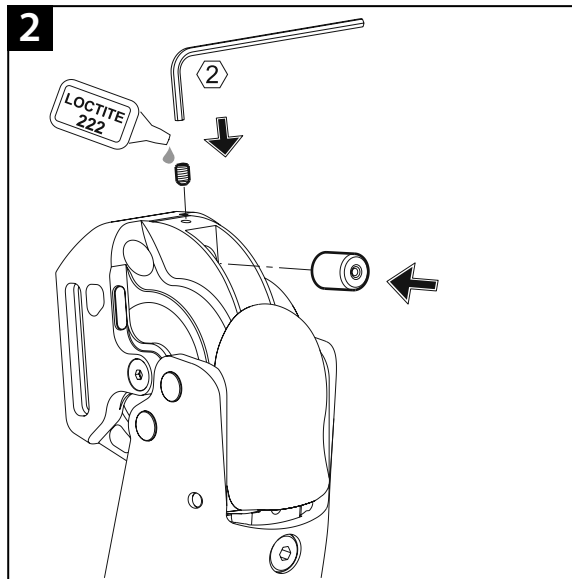

5 Removing ESK+ mechanism

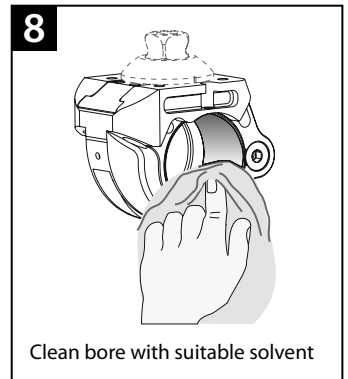
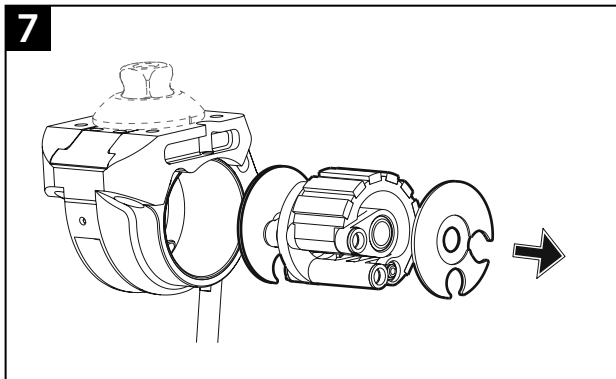
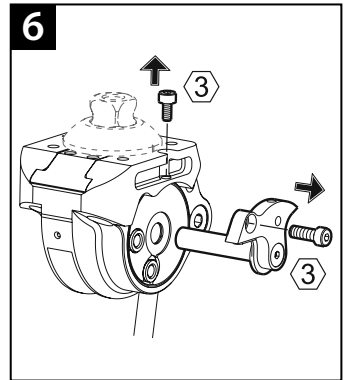
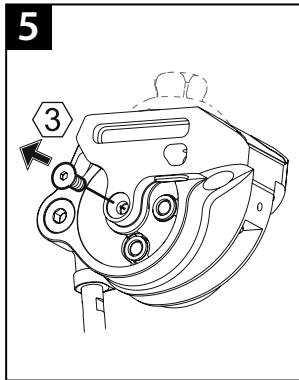
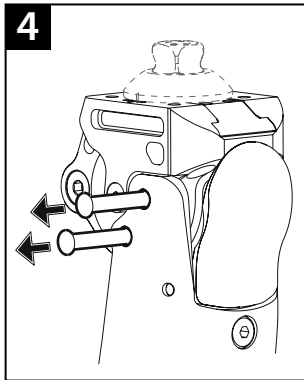
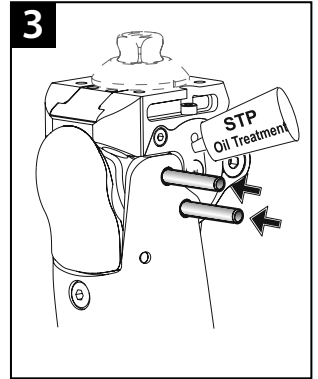
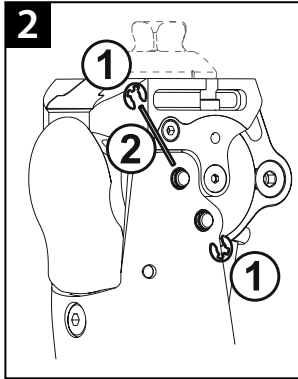
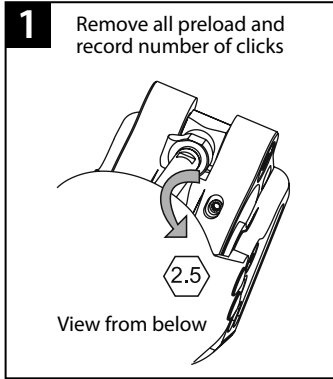

6 Replacement of ESK+ mechanism

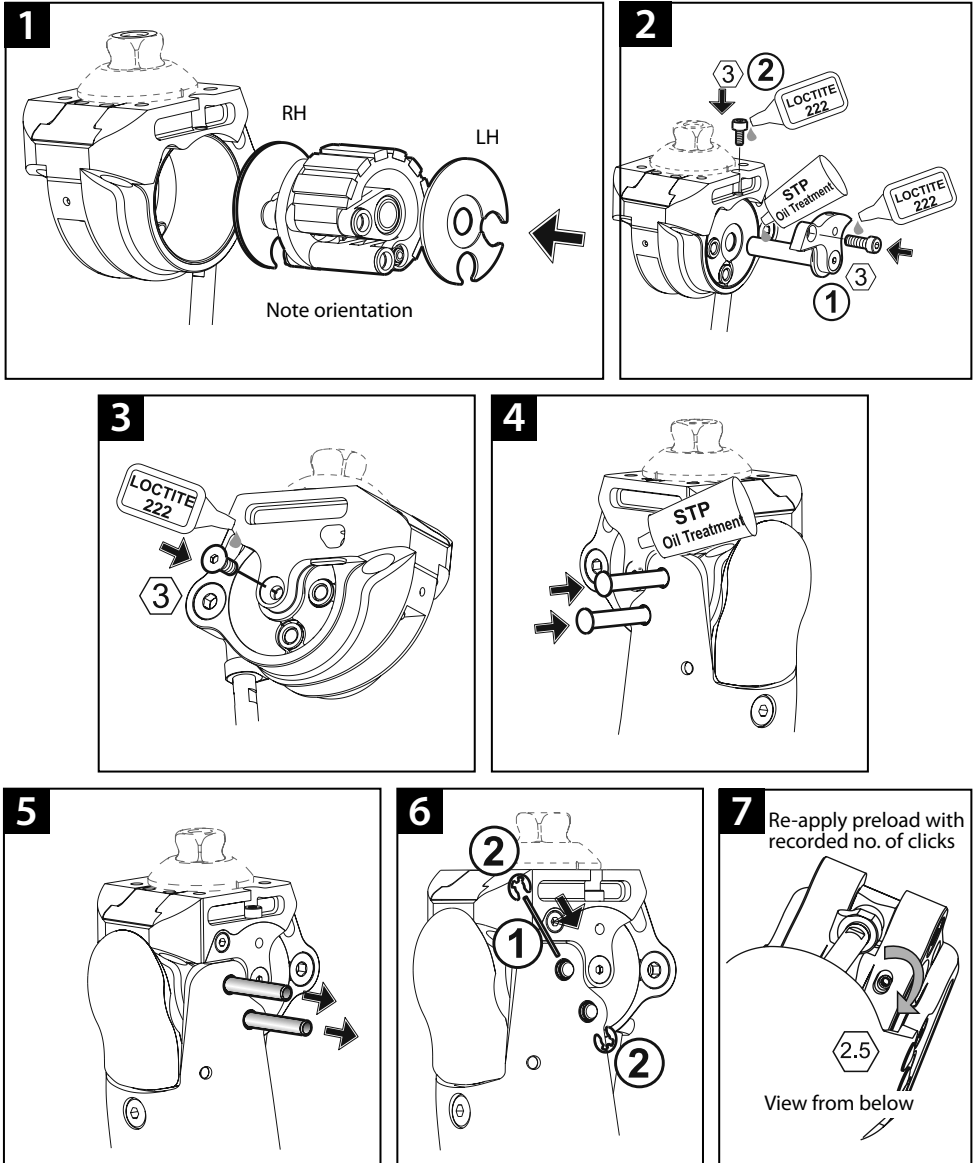

Distributor/Distributeur/Händler/Distributore/Distribuidor

Head Office

Chas A Blatchford & Sons Ltd
Lister Road
Basingstoke
Hampshire
RG22 4AH
United Kingdom
Tel: +44 (0) 1256 316600
Fax: +44 (0) 1256 316617
Email: sales@blatchford.co.uk
www.endolite.co.uk

Customer Services UK

Prosthetic and Orthotic Products
11 Atlas Way
Atlas North
Sheffield
S4 7QQ
United Kingdom
Tel: +44 (0) 114 263 7900
Fax: +44 (0) 114 263 7901
Email: sales@blatchford.co.uk
www.endolite.co.uk

endolite North America

1031 Byers Road
Miamisburg
Ohio 45342
USA
Tel: 800.548.3534
Fax: 800.929.3636
Email: info@endolite.com
www.endolite.com

endolite Germany

Endolite Deutschland GmbH
Holzstr. 5
95336 Mainleus
GERMANY
Tel: +49 9229 9737 001
Fax: +49 9229 9737 006
Email: info@endolite.de
www.endolite.de

endolite France

Parc d'Activités de l'Aéroport, 125 Impasse
Jean-Baptiste Say
34470 PEROLS
FRANCE
Tel: 00 33 (0) 467 820 820
Fax: 00 33 (0) 467 073 630
Email: contact@endolite.fr
www.endolite.fr

endolite India Ltd

A4 Naraina Industrial Area
Phase - 1
New Delhi
INDIA – 110028
Tel: 91 11 45689955
Fax: 91 11 25891543
Email: endolite@vsnl.com
www.endoliteindia.com

