

# ENDOLITE

Fitting Instructions - Smart IP swing control cylinder 239629  
Notice de Réglage – Unité de contrôle de phase pendulaire Smart IP 239629  
Montageanleitung - Smart IP Schwungsteuerungszyylinder 239629  
Istruzioni di montaggio – Cilindro di controllo dell'oscillazione Smart IP 239629  
Instrucciones de ajuste – Cilindro de control del balanceo Smart IP 239629

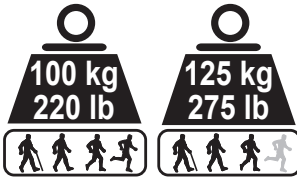

Structural Limitations  
Limitations Structurelles  
Strukturelle Einschränkungen  
Limiti strutturali  
Limitaciones Estructurales



Fitting Kits:  
Full Form shin 019768  
Demountable shin 019668

Notice de réglage:  
Châssis "à couper" 019768  
Châssis avec adaptateur 019668

Anbausätze:  
kompletter Gelenkkörper 019768  
demontierbarer Gelenkkörper 019668

Kit di montaggio:  
Per ginocchi con tibia integrata 019768  
Per ginocchi con tibia smontabile 019668

Kits de ajuste:  
Carcasa completamente integrada 019768  
Carcasa desmontable 019668

GB - pages 1-4  
FR - pages 5-8  
DE - seite 9-12  
IT - pagina 13-16  
ES - pagina 17-20



User/attendant should be aware of potential finger trap hazards at all times.

## SMARTIP cylinder attachment to ESK+ Full Shin (Fitting Kit 019768)

The ESK+ extension stop should be wound fully home. No adjustment is necessary.

**SMARTIPSF**  
**SMARTIP4B**

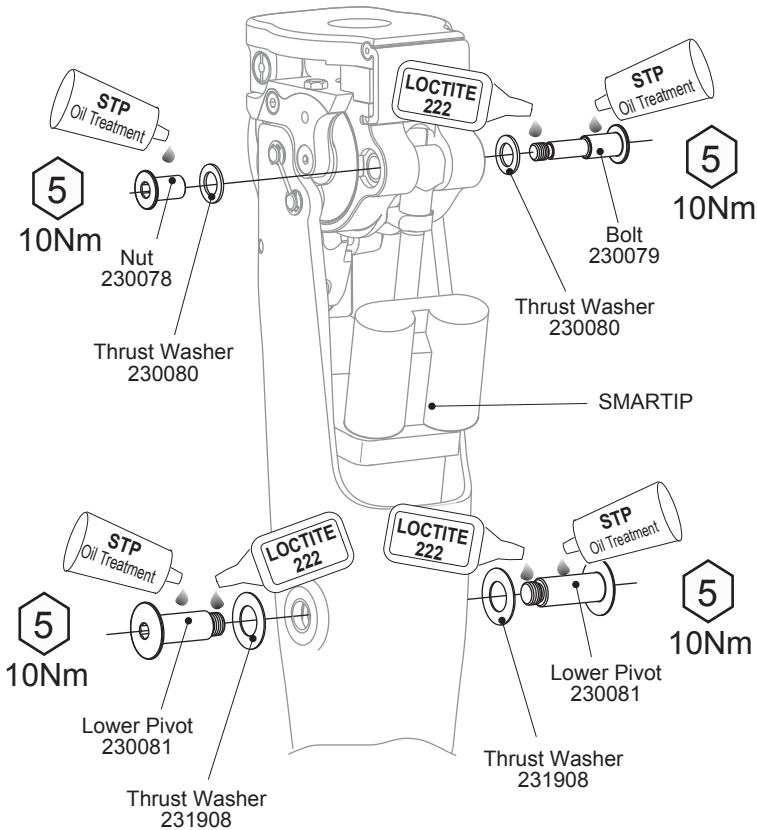
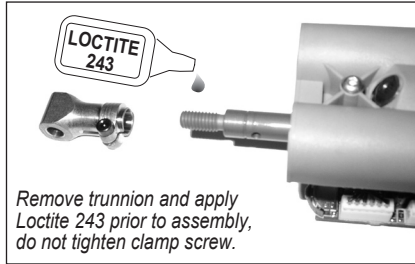

## SMARTIP cylinder attachment to ESK+ Demountable Shin (Fitting Kit 019668)

The ESK+ extension stop should be wound fully home. No adjustment is necessary.

**SMARTIPSF30  
SMARTIPFPYR  
SMARTIP4B30  
SMARTIP4BPYR**

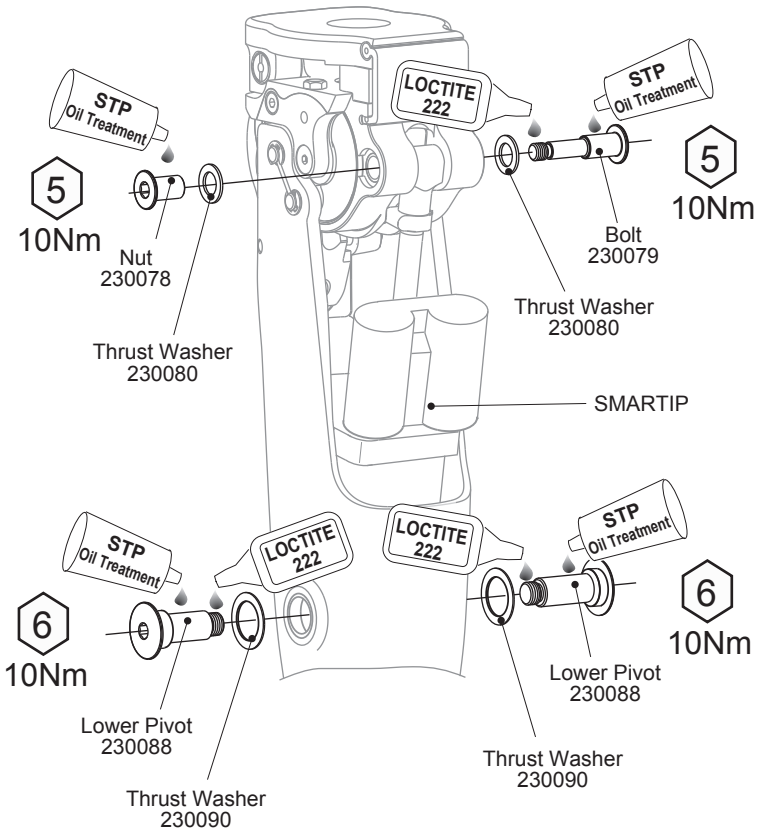
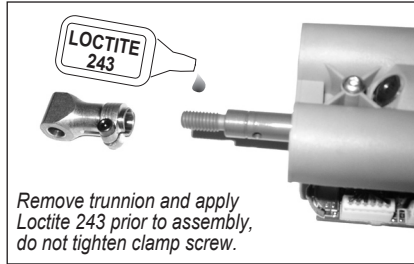

# ENDOLITE

## Length Adjustment

For modules supplied with control cylinder already assembled into the shin, the following has already been carried out.

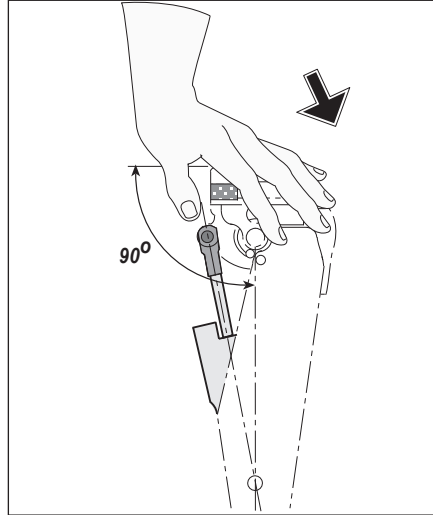
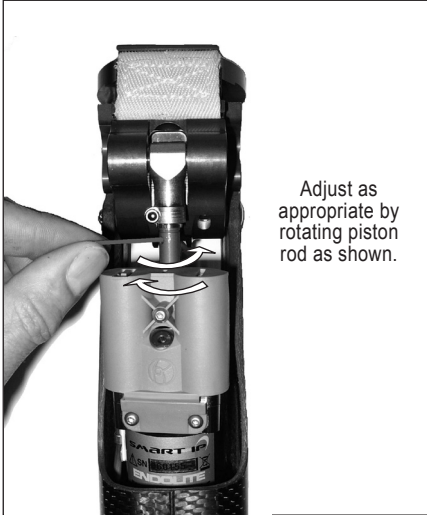

## Battery/Fuse renewal

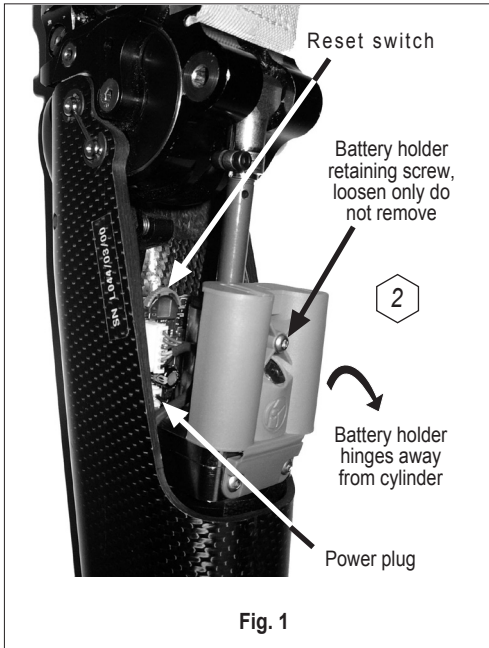

Fig. 1

### Battery removal/renewal (Fig.1)

When the batteries begin to fail a warning is given in the form of ten short beeps being emitted from the limb. The limb will still be usable, and you should seek to replace them at the earliest opportunity. Upon complete battery failure, the limb will emit one long beep. The limb is still safe to use as a medium setting will have been selected, though speed changes will not now occur.

1. Loosen battery holder central retaining screw (2mm A/F Wrench Key).
2. Hinge holder away from cylinder.
3. To remove batteries, depress spring terminal at negative end of each battery and pull out positive end.
4. On refitting, ensure batteries and terminals are clean and note correct polarity as shown inside holder.
5. Hinge holder back to cylinder and tighten retaining screw.
6. Ensure power plug is connected.
7. Press reset switch once, a beep will confirm satisfactory reset.
8. Dispose of used batteries in accordance with manufacturers recommendations.

Battery type: CR123A-3V Lithium Camera Battery

### NOTE

Always replace batteries in pairs.  
Do not store batteries in sunlight, near heat or in moist conditions.

### Replacing the fuse (Fig 1)

Loosen the battery holder retaining screw.

Open battery holder by hinging away from cylinder.

Disconnect power plug from PCB.

Using a suitable thin tool 'hook' the fuse from it's holder and discard. Replace the fuse with new (950043).

Close battery holder and tighten retaining screw.

Reconnect power plug.